

ROAD TYPE	DISTANCE BETWEEN SIGNS IN METERS		
	A	B	C
Urban and Rural ≤ 50 km/h [≤ 30 MPH]	30	30	30
Urban and Rural 60-80 km/h [35-50 MPH]	100	100	100
Rural greater than 80 km/h [50 MPH]	150	150	150
Expressway / Freeway	300	450	800

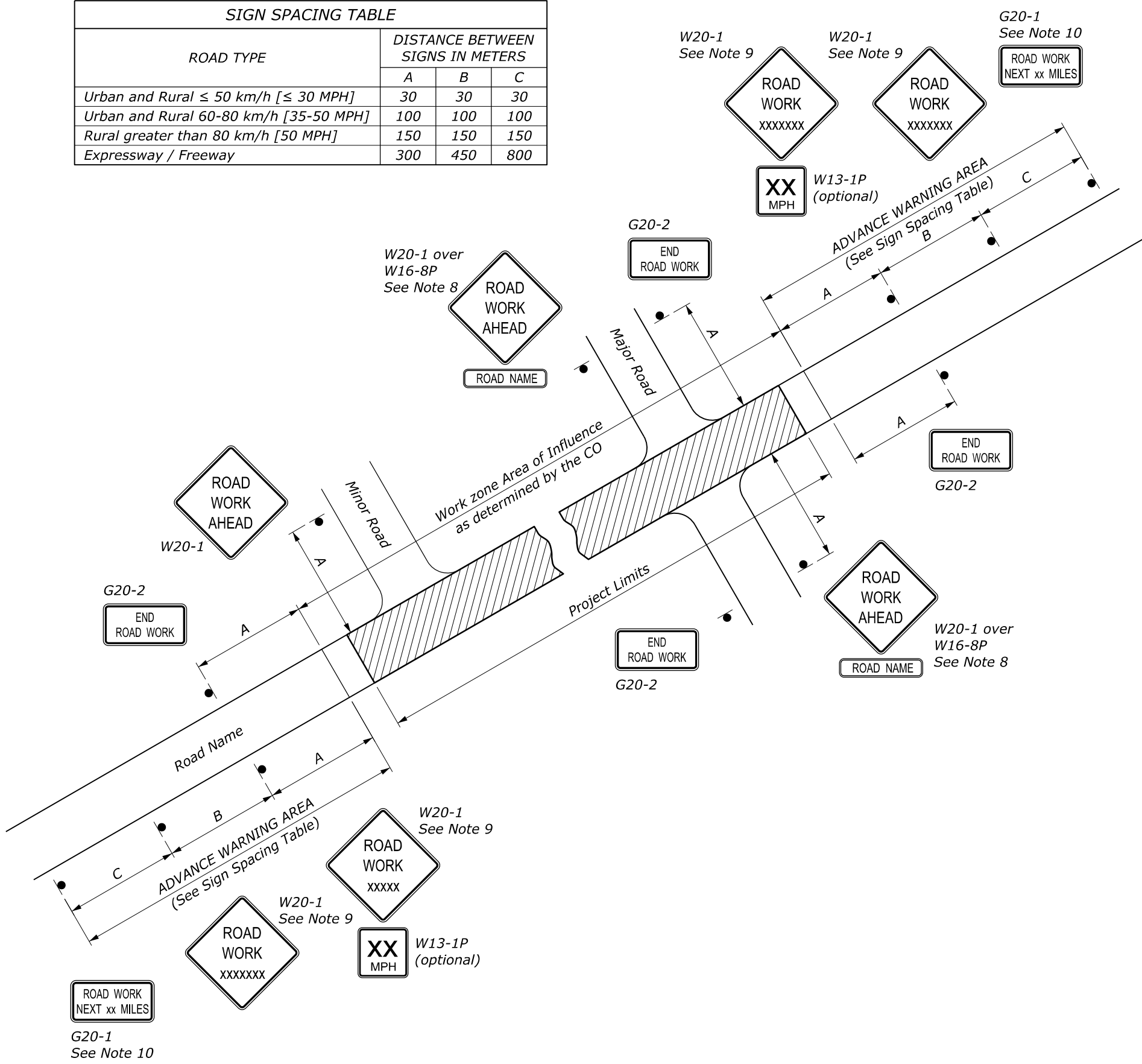

NOTE:

1. Erect all project advance warning signs before starting construction work.
2. Not all details shown on the temporary traffic control sheets may be applicable to this project. The Contractor may add or delete information and details in this traffic control plan as necessary to accommodate actual operations.
3. Where advance warning signs, placed as shown, interfere with permanent signs, locate the warning signs to fit field conditions as approved by the CO. Vary messages as required.
4. Install advisory speed plates under the W20 series warning signs as needed to indicate a maximum recommended speed through the construction area.
5. Ensure all sign supports exposed to impact by traffic meet the requirements of NCHRP-350 or MASH for crashworthiness.
6. Maintain two-way traffic during all non-work hours except as approved by the CO.
7. Do not store traffic control devices along the roadway when not in use. Cover post-mounted signs when not applicable.
8. If W20-1 is placed on a roadway other than that on which the actual construction work occurs, include a supplementary plaque indicating the name of the road on which the construction does occur (applies to major roads only).
9. The message on the W20-1 signs may be ROAD WORK AHEAD or may specify the distance to the work area in feet or in miles. Install an additional W20-1 sign when approach speeds exceed 80 km/h [50 MPH]. When used, place the two W20-1 signs "B" meters apart according to the Sign Spacing Table.
10. For work zones that are greater than 3 km in length, install G20-1 signs at each end of the project. Show the distance on the G20-1 sign to the nearest whole mile.
11. If signing on a roadway under a jurisdiction other than the client agency, verify that an encroachment permit has been obtained.
12. State standards may be used as an alternative if approved by the CO.
13. Refer to Section 635 of the Special Contract Requirements for allowable retroreflective sheeting types.

8 August 2022 2:21 PM C:\pwwork\dm50753\Std635-1.dgn [Std M635-1]

U.S. DEPARTMENT OF TRANSPORTATION FEDERAL HIGHWAY ADMINISTRATION OFFICE OF FEDERAL LANDS HIGHWAY	
METRIC FLH STANDARD TEMPORARY TRAFFIC CONTROL ADVANCE SIGNING	
STANDARD APPROVED FOR USE 6/2005 REVISED: 7/2022	STANDARD M635-1

NO SCALE