

**NOTE:**

1. The pavement on two- or three-lane roads may remain unmarked up to 14 days when providing signs according to this standard. Optionally use the vehicle positioning guides to provide additional delineation.
2. On curves with radius less than 500', reduce cycle length to 20'.
3. Use permanent markings plan to determine no passing zones for each direction of travel.
4. Repeat R4-1 at 1 mile intervals.
5. Repeat W8-12 after each major intersection and every 2 miles for temporary traffic control zones greater than 3 miles long.
6. Use the PASS WITH CARE (R4-2) sign at the downstream end of a no-passing zone only if a DO NOT PASS (R4-1) sign has been installed at the upstream end of the zone.

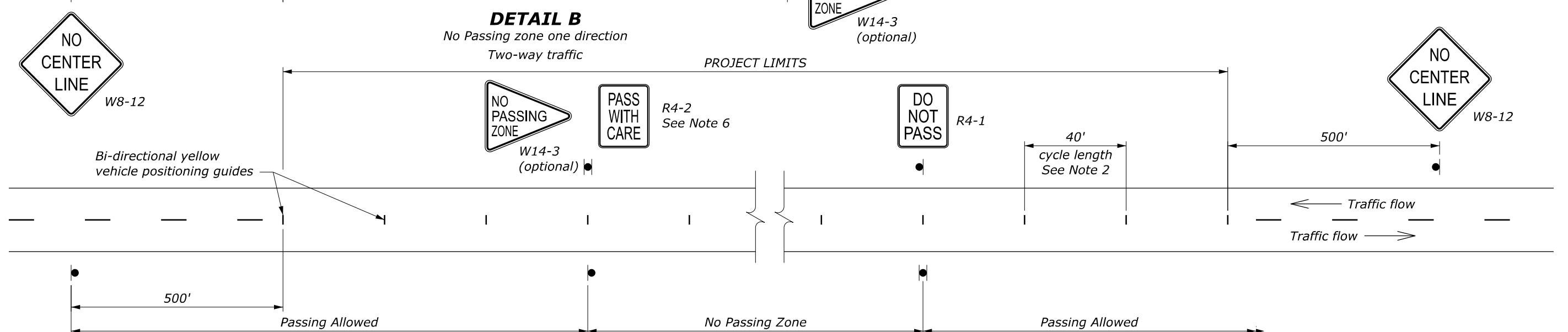
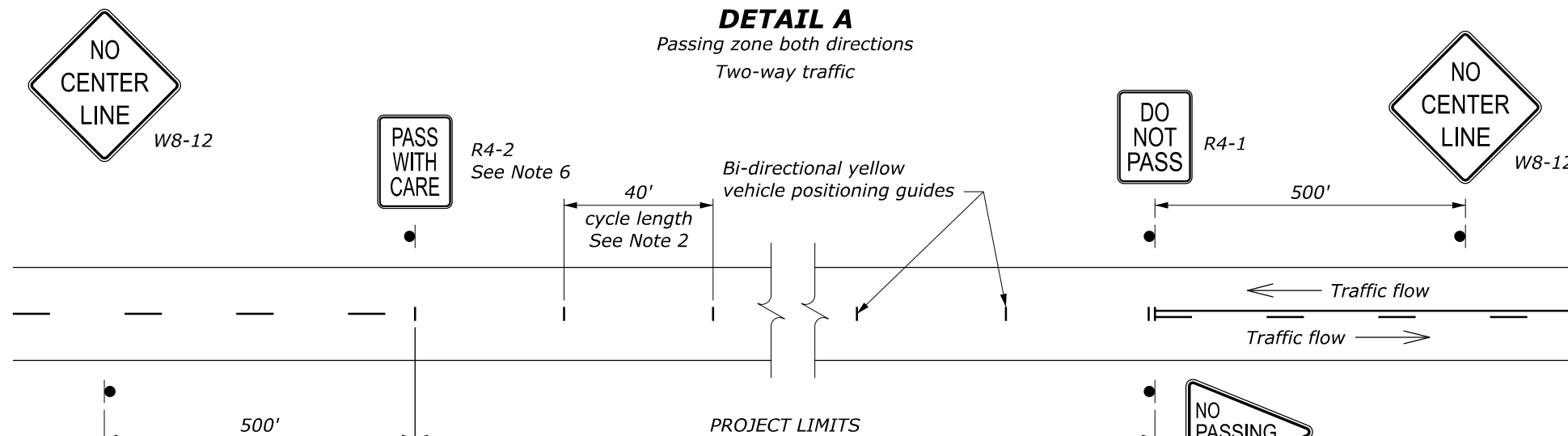
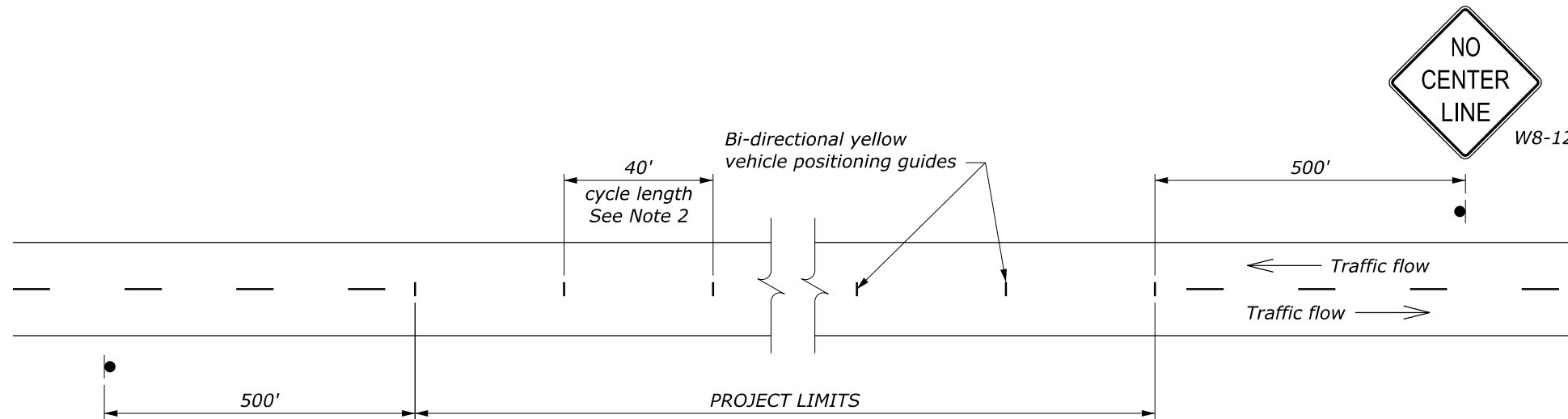

NO SCALE

U.S. DEPARTMENT OF TRANSPORTATION FEDERAL HIGHWAY ADMINISTRATION OFFICE OF FEDERAL LANDS HIGHWAY	
FLH STANDARD	
<b>DELINEATION AND SIGNING FOR UNMARKED PAVEMENTS</b>	
STANDARD APPROVED FOR USE 6/2005 REVISED: 7/2022	STANDARD 635-3