

Wood Post

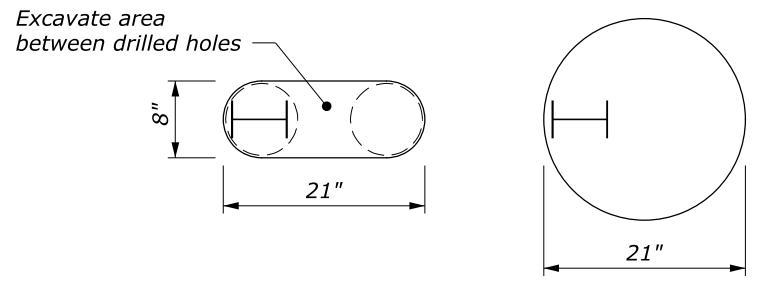

Steel Post

PLAN VIEW

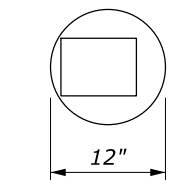

Wood Post

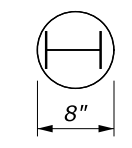

Steel Post

PLAN VIEW

NOTES:

1. Use this Detail when posts cannot be embedded to the minimum depth shown on Details ET 617-10 or ET 617-11.
2. Unless otherwise specified, use either the circular or the oblong hole configuration for Case 1 conditions.
3. Use crushed coarse aggregate backfill that conforms to "coarse aggregate for concrete" or "granular backfill for underdrain pipe with geotextile" in Section 703.
4. Place crushed coarse aggregate according to the post requirements in Section 617.
5. Treat field cut galvanized steel post surfaces that expose the base metal with two coats of zinc-oxide paint.

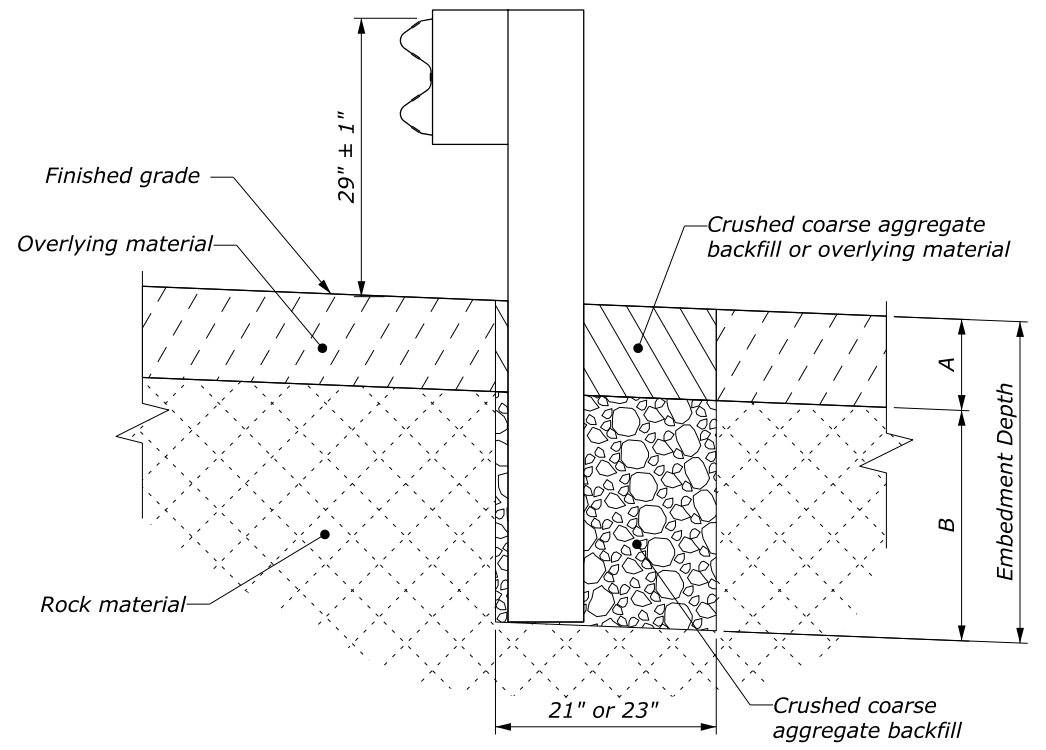

ELEVATION

Case 1: Overlying material depth (A) is 18" or less.

POST EMBEDMENT DIMENSIONS			
HOLE TYPE	EMBEDMENT DEPTH	OVERLYING MATERIAL (A)	DRILLING DEPTH (B)
Case 1	24" to 42"	0 to 18"	24"
Case 2	30" to 42"	> 18" to 30"	12"
	42"	> 30"	42" - A

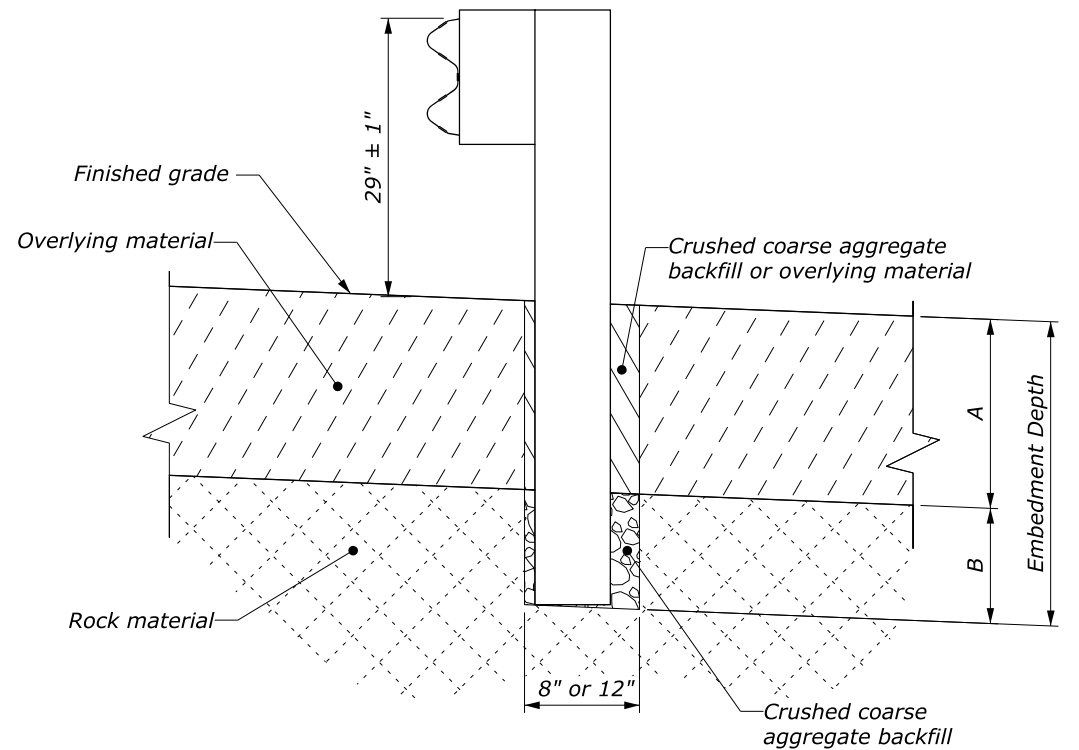

ELEVATION

Case 2: Overlying material depth (A) is greater than 18".

NO SCALE

U.S. DEPARTMENT OF TRANSPORTATION FEDERAL HIGHWAY ADMINISTRATION OFFICE OF FEDERAL LANDS HIGHWAY	
EFLHD DETAIL	
G4 W-BEAM GUARDRAIL INSTALLATION IN ROCK	
REVISID: 6/2014 5/2016 9/2020	DETAIL ET 617-13