

CROSS SECTION VIEW

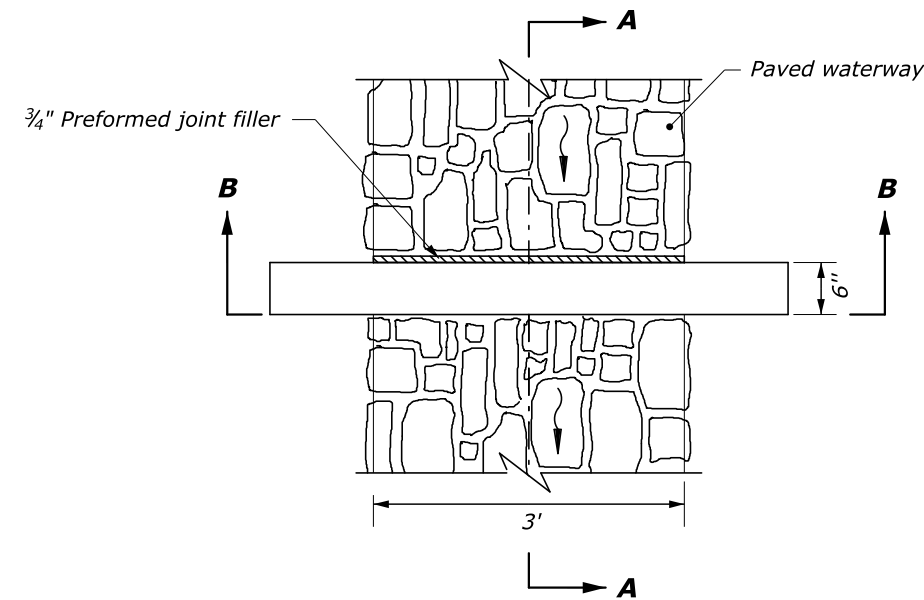

PLAN VIEW

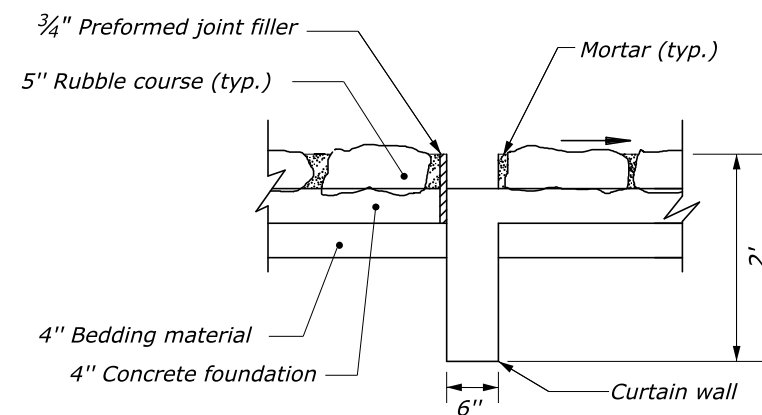

SECTION A-A

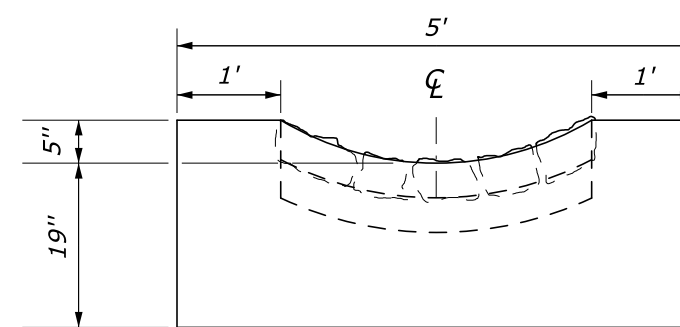

SECTION B-B

**CONCRETE AND RUBBLE PAVED WATERWAY**

**NOTES:**

1. Ensure the approximate shape of the concrete and rubble paved waterway is an arc with a radius of 2.9 feet.
2. At inlets and other special locations, widen and shape paved waterway to drain as approved by the CO.
3. Construct paved waterway in uniform sections of 20 feet in length, except closure sections are not less than 5 feet in length. Place expansion joints, with curtain walls at 100-foot intervals.
4. At the outlet end of each paved waterway, construct a curtain wall on the downstream end of the last section of the waterway.

29-Oct-2020 11:32 AM M:\Standards\_and\_Details\EFHLD\_Detail\Drawings\Working\_Docs\E608\_Detail\sf60803\_detail.dgn

NO SCALE

U.S. DEPARTMENT OF TRANSPORTATION FEDERAL HIGHWAY ADMINISTRATION EASTERN FEDERAL LANDS HIGHWAY DIVISION	
U.S. CUSTOMARY DETAIL	
<b>PAVED WATERWAY, TYPE 3 (CONCRETE AND RUBBLE)</b>	
DETAIL APPROVED FOR USE	DETAIL
APPROVED: MAY 2011 REVISED: SEPTEMBER 2020	E608-03